

Specifications & Options

CNC LATHES
SL SERIES

Power Diagram

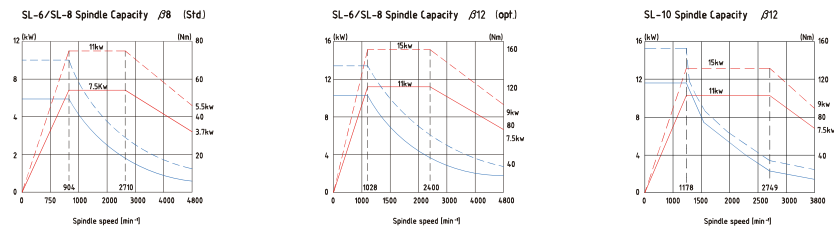

Power Diagram

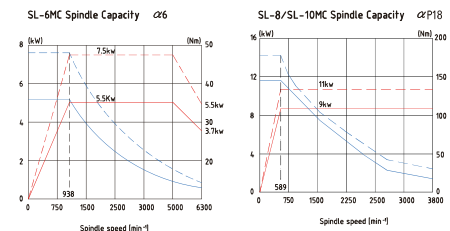

Machine Dimension

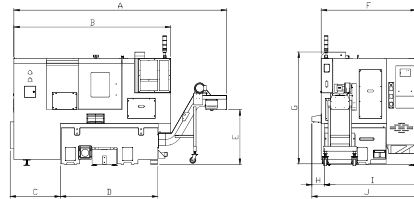

model	A	B	C	D	E	F	G	H	I	K
SL-6/8/10	3435	2335	660	1590	893	1556	1827	152	1578	1780
SL-6/8/10MC	3477	2564	820	1590	893	1556	1827	202	1578	1780

SPEC.	UNIT	SL-6	SL-6MC	SL-8	SL-8MC	SL-10	SL-10MC
SWING OVER BED	mm	420	420	420	420	420	420
OVER CROSS SLIND	mm	340	340	340	340	340	340
MAX. TURNING DIA.	mm	320	230	320	250	320	250
MAX. WORK LENGTH	mm	500	490	490	480	475	465
DRAW TUBE BORE	mm	45	45	52	52	75	75
CHUCK SIZE	inch	6"	6"	8"	8"	10"	10"
SPINDLE DRIVE MOTOR	KW	7.5/11	5.5/7.5	7.5/11	9/11	11/15	9/11
MAX SPINDLE SPEED	rpm	4500 (6000 opt.)	4500 (6000 opt.)	4500 (4800 opt.)	4500 (4800 opt.)	3800 (4200 opt.)	3800 (4200 opt.)
MILLING SPEED RANGE	rpm	4000					
SPINDLE NOSE		A2-5	A2-5	A2-6	A2-6	A2-8	A2-8
THROUGH SPINDLE HOLE DIA.	mm	51	51	62	62	90	90
FRONT BEARING DIA.	mm	80	80	100	100	130	130
SPINDLE TAPER		1/20	1/20	1/20	1/20	1/20	1/20
X AXIS TRAVEL	mm	180	175	185	215	185	215
Z AXIS TRAVEL	mm	520	520	520	520	510	510
X AXIS MOTOR	KW	1.2	1.6	1.2	1.6	1.8	1.6
Z AXIS MOTOR	KW	1.2	1.4	1.2	3.0	1.8	3.0
X AXIS RAPID TRAVERSE	m/min	24	24	24	24	24	24
Z AXIS RAPID TRAVERSE	m/min	24	24	24	24	24	24
GUIDEWAYS		Linear	Linear	Linear	Linear	Linear	Linear
NO. OF TOOL STATIONS		8	12	10(opt. 6+6)	12	10(opt. 6+6)	12
SIZE OF EXTER. TURNING TOOL	mm	20	16	25	20	25	20
BORING BAR DIA.	mm	32	32	40	32	40	32
QUILL DIA.	mm	58	58	58	58	58	58
QUILL TRAVEL	mm	88	88	88	88	88	88
TAILSTOCK TRAVEL	mm	410	410	410	410	410	410
QUILL TAPER		MT#4	MT#4	MT#4	MT#4	MT#4	MT#4
ELECTRICAL POWER SUPPLY	KVA	21	21	21	25	25	25
COOLANT TANK CAPACITY	Liter	100	100	100	100	100	100
COOLANT FLOW	L/min	20	20	20	20	20	20
TOTAL HEIGHT	mm	1580	1580	1580	1580	1580	1580
FLOOR SPACE LENGTH	mm	2550	2700	2550	2700	2700	2700
FLOOR SPACE WIDTH	mm	1550	1600	1550	1600	1600	1600
NET WEIGHT	kg	3310	3350	3350	3400	3450	3500

STANDARD ACCESSORIES

- 3 jaw hydraulic chuck
- Hydraulic tailstock
- Hydraulic system
- Coolant system
- Auto lubrication system
- Heat exchanger
- Work light equipment
- Hand wheel
- Foot switch for chuck clamp
- OD tool holder
- Facing tool holder
- Boring bar holder & sleeves
- Drill sleeves
- Live center
- Morse taper Sleeve
- Tool box
- Levelling pads
- Operation & maintenance manuals

OPTIONAL ACCESSORIES

- Chip conveyor
- Chip bucket
- Transformer
- Parts catcher
- Parts conveyor
- Tool setter
- Auto Door
- Bar feeder
- Bar feeder interface (LNS system)
- CE mark
- Hoisting hook package
- Levelling kit
- Additional tool holders and sleeves

ECOCA®

—Focus on every detail—

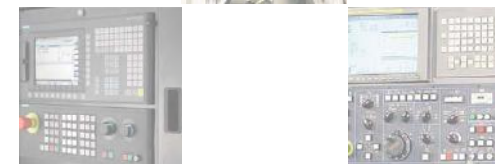
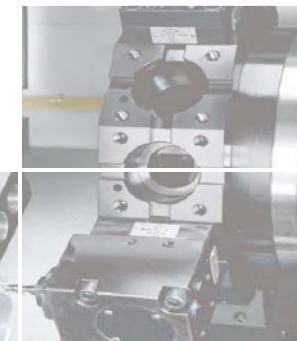

All specifications, designs and characteristics shown in this catalogue are subject to change without prior notice.
Motor specifications are based on machine with Fanuc controller.

ECOCA
—Focus on every detail—

ECOCA INDUSTRIAL CO., LTD.

401, 28TH ROAD, TAICHUNG INDUSTRIAL PARK, TAICHUNG, TAIWAN.

TEL: +886-4-23597666 FAX: +886-4-23597669 http://www.ecoca.com E-mail: biz@ecoca.com

13-03.15-02/4E-1000-R08

ECOCA
—Focus on every detail—



SL-6/SL-6MC
SL-8/SL-8MC
SL-10/SL-10MC

Meeting the various demands of the metal turning jobs.

- 30 degree slant design provides turning stability and easy chip removal.
- Linear guideways on both axes to reduce machining time and increase accuracy.
- Hydraulic tank with cooling unit equipped to reduce heat dissipation and enhance stability.



Power turret (opt.)



Tool setter provides quick and easy tooling set up (opt.)



- Ultimate rib design result in a very rigid and sturdy structure.
- Big turret disc provides easiness in tool installation. Built-in coolant nozzles and channels are also provided in the turret disc.
- PLC controlled chip conveyor (when applicable) increases productivity.

Tool Interference Diagram

